

REVISIONS		
4-13-2007	CRAIG F. REMINGTON	23924
3-8-2012	CRAIG F. REMINGTON	23924
4-24-2014	CRAIG F. REMINGTON	23924
1-30-2017	CHARLES E. ADAMSON	42627

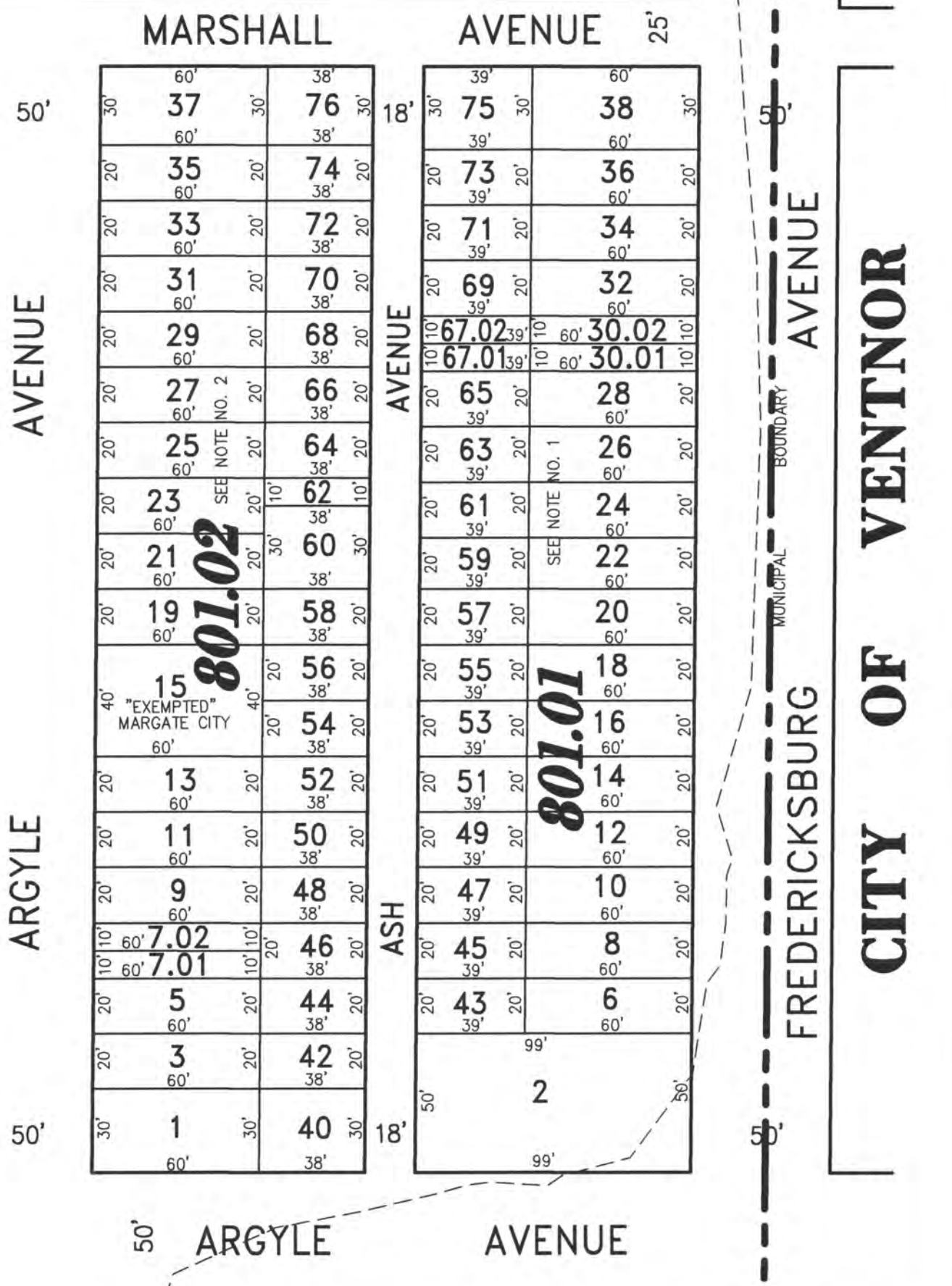
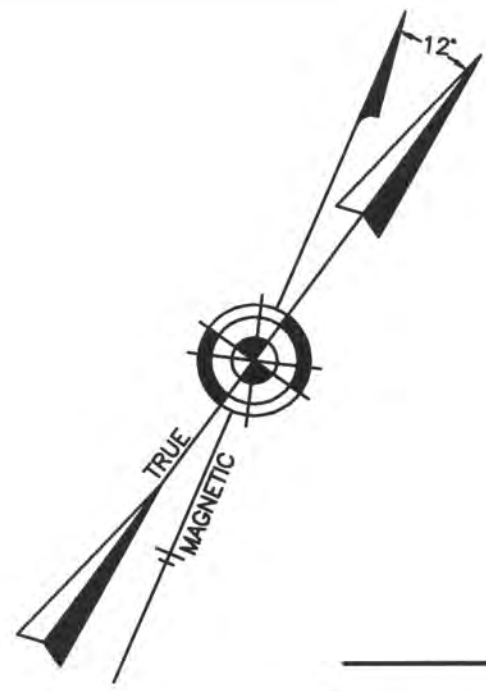

DETAIL "A"
SCALE: 1"=50'

NOTES:

1. BLOCK 801.01, LOTS 6, 8, 10, 12, 14, 16, 18, 20, 22, 24, 26, 28, 30.01, 30.02, 32, 34, 36, 38, 40, 42, 44, 46, 48, 50, 52, 54, 56, 58, 60, 62, 64, 66, 68, 70, 72, 74, & 76 ARE ALL EXEMPTED PROPERTIES, OWNED BY THE CITY OF MARGATE.
2. BLOCK 801.02, LOTS 1, 3, 5, 7.01, 7.02, 9, 11, 13, 19, 21, 23, 25, 27, 29, 31, 33, 35, 37, 40, 42, 44, 46, 48, 50, 52, 54, 56, 58, 60, 62, 64, 70, 72, 74, & 76 ARE ALL EXEMPTED PROPERTIES, OWNED BY THE CITY OF MARGATE.
3. BLOCK 802.01, LOTS 1, 2, 8, 9, 15, & 16 ARE ALL EXEMPTED PROPERTIES, OWNED BY THE CITY OF MARGATE.
4. BLOCK 802.02, LOTS 1-20 ARE ALL EXEMPTED PROPERTIES, OWNED BY THE CITY OF MARGATE.
5. BLOCK 803.01, LOTS 1-4, 10, 11, & 18-20 ARE ALL EXEMPTED PROPERTIES, OWNED BY THE CITY OF MARGATE.
6. BLOCK 803.02, LOTS 1-20 ARE ALL EXEMPTED PROPERTIES, OWNED BY THE CITY OF MARGATE.
7. BLOCK 807.01, LOTS 5-8, 17-24, & 29-32 ARE ALL EXEMPTED PROPERTIES, OWNED BY THE CITY OF MARGATE.
8. BLOCK 903.01, LOTS 1-11, & 15-20 ARE ALL EXEMPTED PROPERTIES, OWNED BY THE CITY OF MARGATE.
9. BLOCK 903.02, LOTS 1-3, & 8-20 ARE ALL EXEMPTED PROPERTIES, OWNED BY THE CITY OF MARGATE.
10. BLOCK 907.01, LOTS 5-8, 17-24, & 29-32 ARE ALL EXEMPTED PROPERTIES, OWNED BY THE CITY OF MARGATE.
11. BLOCK 1007.01, LOTS 5-8, 17-24, & 29-32 ARE ALL EXEMPTED PROPERTIES, OWNED BY THE CITY OF MARGATE.

"THIS TAX MAP PLATE HAS BEEN DIGITALLY DRAWN USING COMPUTER-AIDED DRAFTING/DESIGN (CADD) & COORDINATE GEOMETRY (COGO). IT IS BASED ON THE ORIGINAL DIGITALLY DRAWN TAX MAP PLATE BEARING THE OFFICIAL NEW JERSEY DIVISION TAXATION APPROVAL STAMP WITH APPROVAL DATE 6-3-2005 SERIAL NUMBER 846 AND SIGNATURES OF SIGNERS' THOMAS J. REILLY, CHIEF, LOCAL PROPERTY, FIELD ASSISTANCE, SANTO C. DIDONATO, SUPERVISING FIELD REPRESENTATIVE. THE ORIGINAL DIGITALLY DRAWN TAX MAP PLATE WITH THE OFFICIAL APPROVAL STAMP IS ON FILE WITH REMINGTON, VERNICK & WALBERG ENGINEERS."

TAX MAP
CITY OF MARGATE

ATLANTIC COUNTY NEW JERSEY
SCALE: 1" = 100' DATE: 11-01-2003

CRAIG F. REMINGTON LAND SURVEYOR LIC. NO. 23924



REMINGTON, VERNICK & WALBERG ENGINEERS
24 GA 28048700
845 N. MAIN STREET, PLEASANTVILLE, N.J. 08232
(609) 645-700, FAX (609) 645-7076
WEB SITE ADDRESS: WWW.RVE.COM