

REVISIONS  
WPHA 1-10-91  
WPHA 1-13-92

See Adjoining Sheet 45

See Adjoining Sheet 37

See Adjoining Sheet 36.04

See Adjoining Sheet 42.04

See Adjoining Sheet 43

See Adjoining Sheet 43.02

See Adjoining Sheet 43.04

See Adjoining Sheet 43.01

See Adjoining Sheet 48

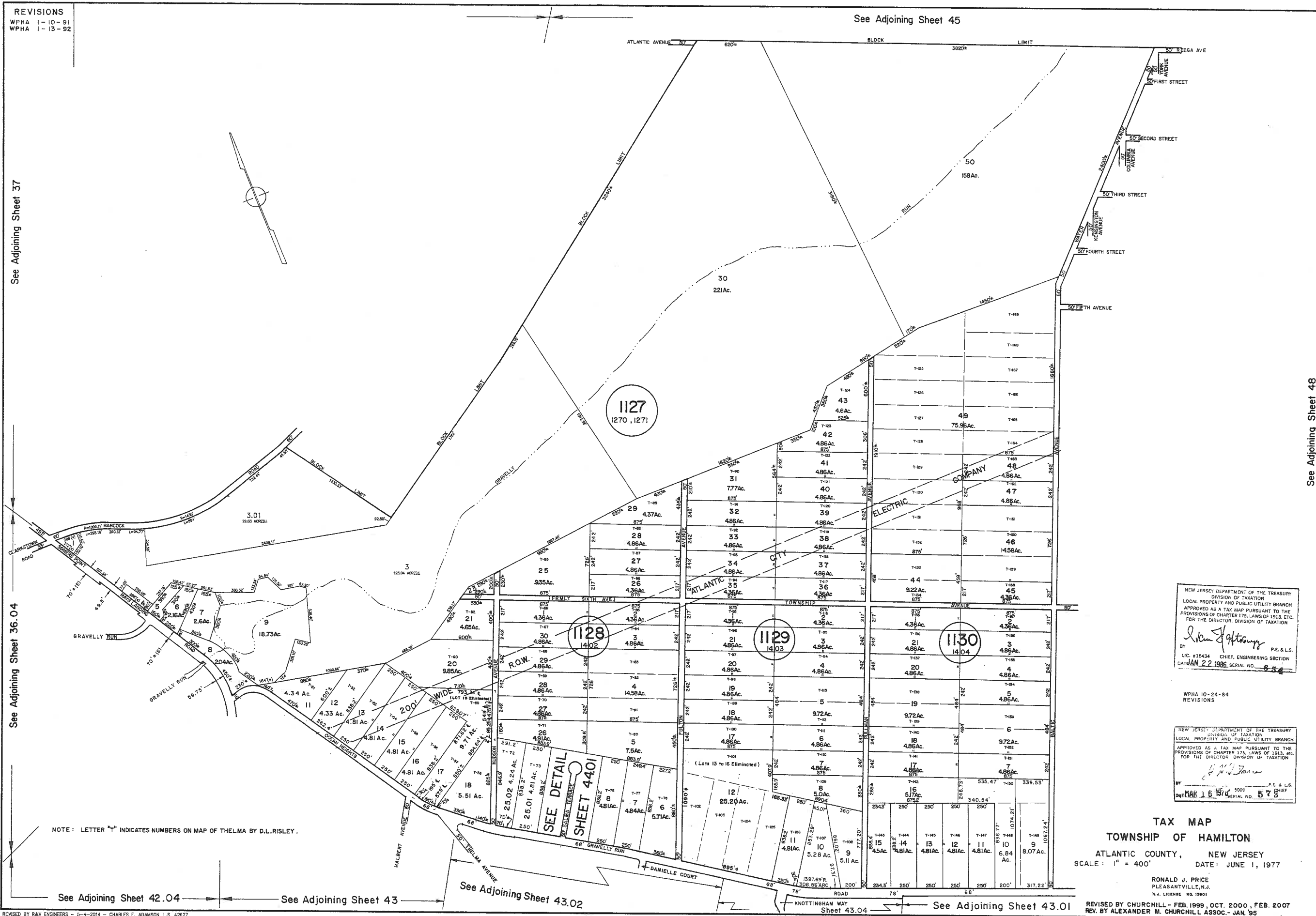

NOTE: LETTER "T" INDICATES NUMBERS ON MAP OF THELMA BY D.L. RISLEY.

NEW JERSEY DEPARTMENT OF THE TREASURY  
DIVISION OF TAXATION  
LOCAL PROPERTY AND PUBLIC UTILITY BRANCH  
APPROVED AS A TAX MAP PURSUANT TO THE  
PROVISIONS OF CHAPTER 175, LAWS OF 1913, ETC.  
FOR THE DIRECTOR, DIVISION OF TAXATION

*Richard J. Adams*  
P.E. & L.S.  
LIC. #16434  
DATE: JAN 22 1996  
SERIAL NO. 654

WPHA 10-24-84  
REVISIONS

NEW JERSEY DEPARTMENT OF THE TREASURY  
DIVISION OF TAXATION  
LOCAL PROPERTY AND PUBLIC UTILITY BRANCH  
APPROVED AS A TAX MAP PURSUANT TO THE  
PROVISIONS OF CHAPTER 175, LAWS OF 1913, ETC.  
FOR THE DIRECTOR, DIVISION OF TAXATION

*John J. Adams*  
P.E. & L.S.  
LIC. #16434  
DATE: MAY 16 1995  
SERIAL NO. 573

**TAX MAP**  
**TOWNSHIP OF HAMILTON**  
ATLANTIC COUNTY, NEW JERSEY  
SCALE: 1" = 400'  
DATE: JUNE 1, 1977

RONALD J. PRICE  
PLEASANTVILLE, N.J.  
N.J. LICENSE NO. 15901

REVISED BY CHURCHILL - FEB. 1999, OCT. 2000, FEB. 2007  
REV. BY ALEXANDER M. CHURCHILL ASSOC. - JAN. '95