

See Adjoining Sheet 26.01

See Adjoining Sheet 26.02

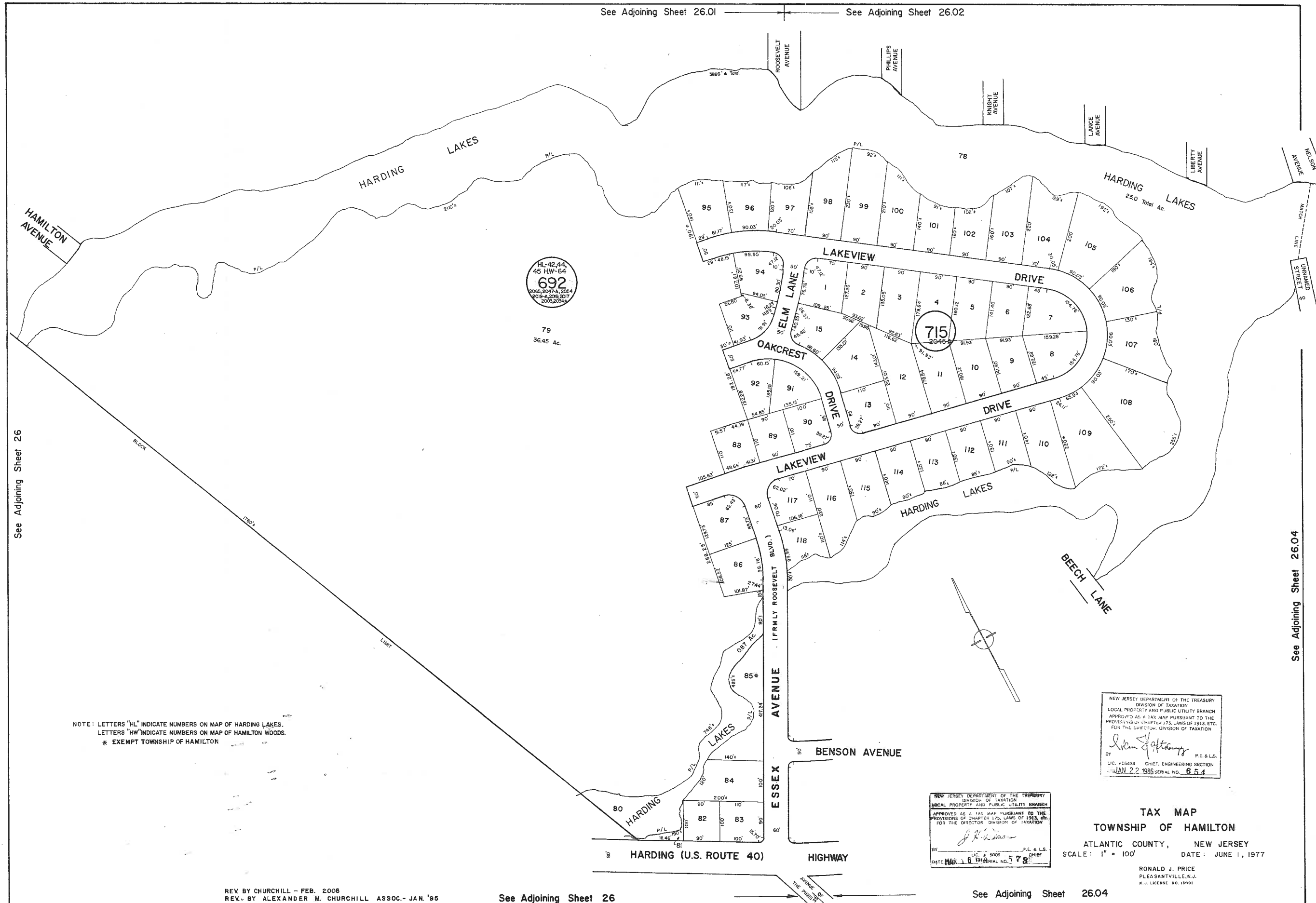

See Adjoining Sheet 26

See Adjoining Sheet 26.04

NOTE: LETTERS "HL" INDICATE NUMBERS ON MAP OF HARDING LAKES.
 LETTERS "HW" INDICATE NUMBERS ON MAP OF HAMILTON WOODS.
 * EXEMPT TOWNSHIP OF HAMILTON

NEW JERSEY DEPARTMENT OF THE TREASURY
 DIVISION OF TAXATION
 LOCAL PROPERTY AND PUBLIC UTILITY BRANCH
 APPROVED AS A TAX MAP PURSUANT TO THE
 PROVISIONS OF CHAPTER 175, LAWS OF 1913, ETC.
 FOR THE CHIEF OF THE DIVISION OF TAXATION
John J. [Signature]
 BY: [Signature] P.E. & L.S.
 LIC. #15434 CHIEF, ENGINEERING SECTION
 JAN 22 1986 SERIAL NO. 654

NEW JERSEY DEPARTMENT OF THE TREASURY
 DIVISION OF TAXATION
 LOCAL PROPERTY AND PUBLIC UTILITY BRANCH
 APPROVED AS A TAX MAP PURSUANT TO THE
 PROVISIONS OF CHAPTER 175, LAWS OF 1913, ETC.
 FOR THE DIRECTOR DIVISION OF TAXATION
[Signature]
 BY: [Signature] P.E. & L.S.
 LIC. # 5008 CHIEF
 DATE: MAR 1 0 1986 SERIAL NO. 578

TAX MAP
TOWNSHIP OF HAMILTON
 ATLANTIC COUNTY, NEW JERSEY
 SCALE: 1" = 100' DATE: JUNE 1, 1977

RONALD J. PRICE
 PLEASANTVILLE, N.J.
 N.J. LICENSE NO. 13901

REV. BY CHURCHILL - FEB. 2008
 REV. BY ALEXANDER M. CHURCHILL ASSOC. - JAN '95

See Adjoining Sheet 26

See Adjoining Sheet 26.04