

REVISIONS		
DATE	LS NAME	LIC. NO.
8-29-98	MARTIN F. TIRELLA	27477

See Adjoining Sheet 14.07

See Adjoining Sheet 14.06

See Adjoining Sheet 14.08

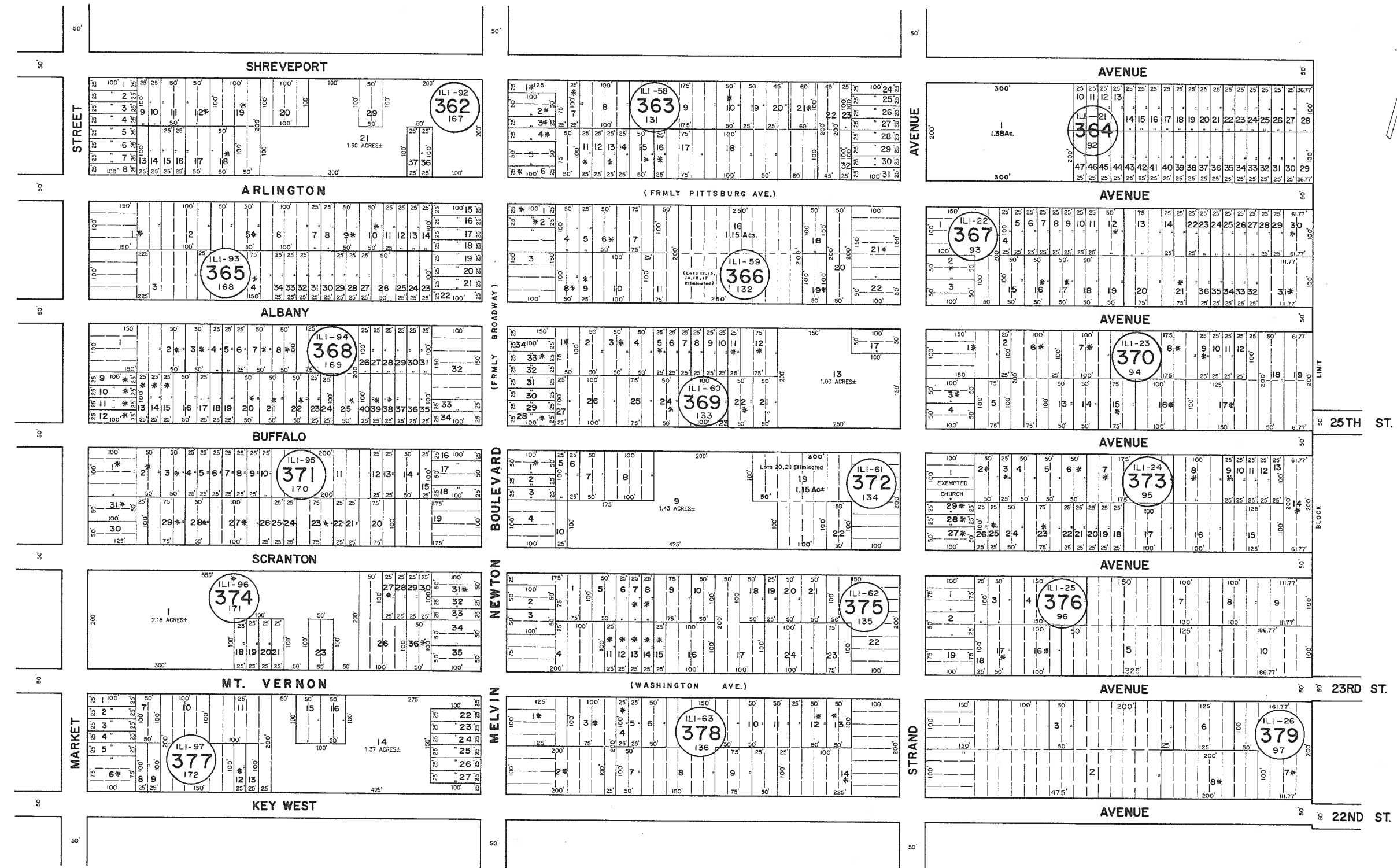

* EXEMPT TOWNSHIP OF HAMILTON
 NOTE: LETTERS "ILI" INDICATES NUMBER ON MAP OF INDUSTRIAL LAND COMPANY

REVISED BY CHURCHILL - FEB. 1999, MAY 2004, FEB. 2008

See Adjoining Sheet 14.10

NEW JERSEY DEPARTMENT OF THE TREASURY
 DIVISION OF TAXATION
 LOCAL PROPERTY AND PUBLIC UTILITY BRANCH
 APPROVED AS A TAX MAP PURSUANT TO THE
 PROVISIONS OF CHAPTER 175, LAWS OF 1913, ETC.
 FOR THE DIRECTOR, DIVISION OF TAXATION
Alexander M. Churchill
 BY: P.E. & S.
 1/15 1/25/88 CHIEF, ENGINEERING SECTION
 JAN 22 1988 SERIAL NO. 654

NEW JERSEY DEPARTMENT OF THE TREASURY
 DIVISION OF TAXATION
 LOCAL PROPERTY AND PUBLIC UTILITY BRANCH
 APPROVED AS A TAX MAP PURSUANT TO THE
 PROVISIONS OF CHAPTER 175, LAWS OF 1913, ETC.
 FOR THE DIRECTOR, DIVISION OF TAXATION
Ronald J. Price
 BY: P.E. & S.
 1/15 1/25/88 CHIEF, ENGINEERING SECTION
 MAR 10 1978 SERIAL NO. 575

TAX MAP
 TOWNSHIP OF HAMILTON
 ATLANTIC COUNTY, NEW JERSEY
 SCALE: 1" = 100'
 DATE: JUNE 1, 1977

RONALD J. PRICE
 PLEASANTVILLE N.J.
 N.J. LICENSE NO. 18001

REV. BY REMINGTON & VERNICK ENGINEERS - 1-31-2010
 REV. BY REMINGTON & VERNICK ENGINEERS - 3-10-2011
 REV. BY REMINGTON & VERNICK ENGINEERS - 1-8-2013