

REVISIONS
WPHA 1-14-92

See Adjoining Sheet 5.08

See Adjoining Sheet 14.03

See Adjoining Sheet 14

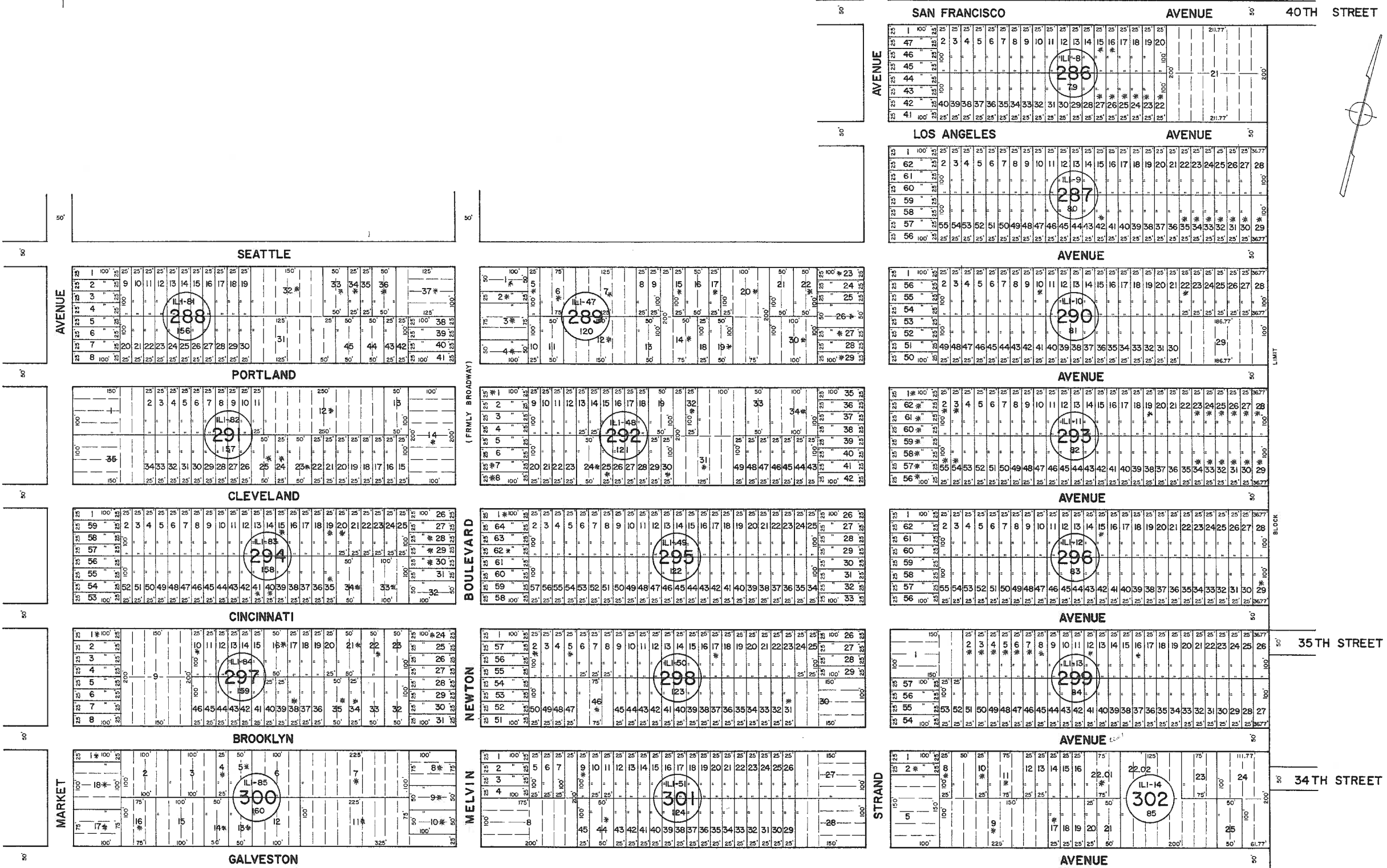

NOTE: LETTERS "LI" INDICATE NUMBERS ON MAP OF INDUSTRIAL LAND COMPANY.
* EXEMPT TOWNSHIP OF HAMILTON

REVISED BY R&V - 1-8-2013
REV. BY CHURCHILL - FEB. 2008
REV. BY ALEXANDER M. CHURCHILL ASSOC. - JAN. '95

See Adjoining Sheet 14.07

NEW JERSEY DEPARTMENT OF THE TREASURY
DIVISION OF TAXATION
LOCAL PROPERTY AND PUBLIC UTILITY BRANCH
APPROVED AS A TAX MAP PURSUANT TO THE
PROVISIONS OF CHAPTER 175, LAWS OF 1913, ETC.
FOR THE DIRECTOR, DIVISION OF TAXATION

John J. Hoffmann
P.E. & L.S.
LIC. #15434
DATE: JAN 22 1998 SERIAL NO. 654

NEW JERSEY DEPARTMENT OF THE TREASURY
DIVISION OF TAXATION
LOCAL PROPERTY AND PUBLIC UTILITY BRANCH
APPROVED AS A TAX MAP PURSUANT TO THE
PROVISIONS OF CHAPTER 175, LAWS OF 1913, ETC.
FOR THE DIRECTOR, DIVISION OF TAXATION

J. N. Williams
P.E. & L.S.
LIC. #5009
DATE: MAR 16 1974 SERIAL NO. 578

TAX MAP
TOWNSHIP OF HAMILTON
ATLANTIC COUNTY, NEW JERSEY
SCALE: 1" = 100'
DATE: JUNE 1, 1977

RONALD J. PRICE
PLEASANTVILLE, N.J.
N.J. LICENSE NO. 19001