

REVISIONS			
DATE	BY	LIC. NO.	COMMENTS
6/18/10	JAM	2991B	
1/10/13	JAM	2991B	
12/26/14	JAM	2991B	

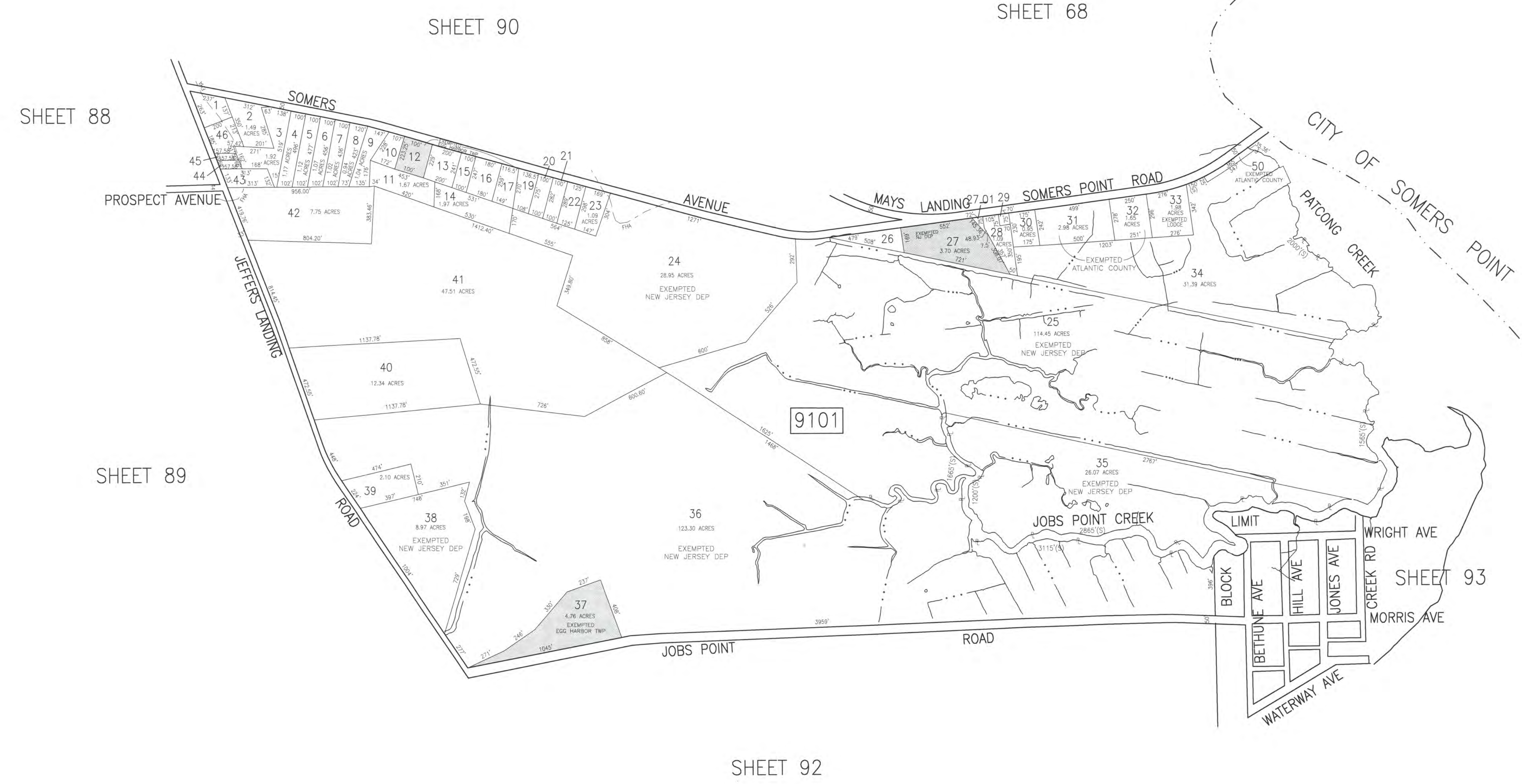
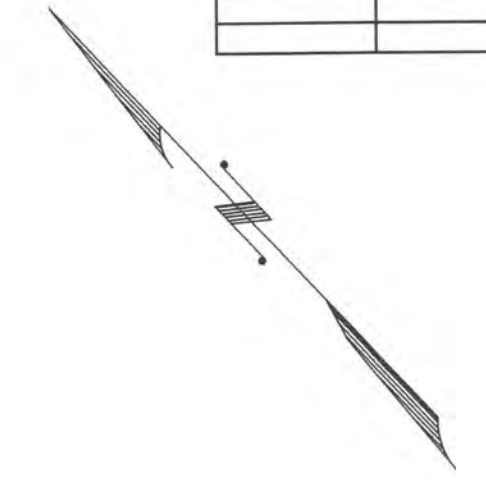

THIS SHEET HAS BEEN DRAWN USING  
COMPUTER AIDED DRAFTING/DESIGN (CAD/D).

TAX MAP  
TOWNSHIP OF EGG HARBOR  
ATLANTIC COUNTY, NEW JERSEY  
SCALE: 1"=400'  
JANUARY 2008  
JAMES A. MOTT, PE, PLS  
PROFESSIONAL ENGINEER & LAND SURVEYOR  
NEW JERSEY LICENSE NO. 2991B  
3122 FIRE ROAD  
EGG HARBOR TOWNSHIP, NJ 08234