

REVISIONS			
DATE	BY	LIC. NO.	COMMENTS
6/18/10	JAM	29918	
7/12/10	JAM	29918	
11/30/10	JAM	29918	
12/28/14	JAM	29918	
2/19/15	JAM	29918	

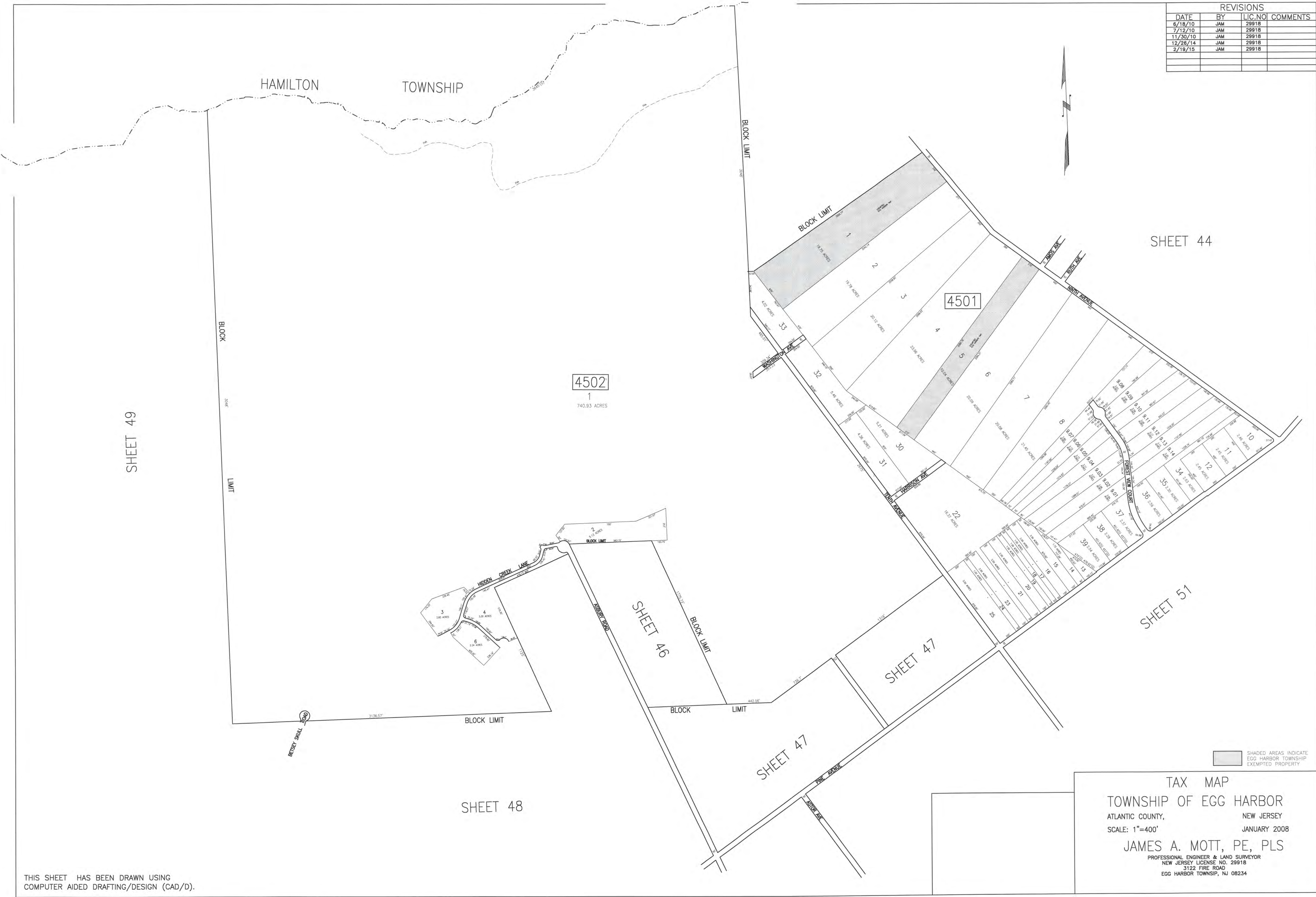

HAMILTON TOWNSHIP

SHEET 44

SHEET 49

4502
1
740.93 ACRES

SHEET 51

SHEET 46

SHEET 47

SHEET 48

TAX MAP
 TOWNSHIP OF EGG HARBOR
 ATLANTIC COUNTY, NEW JERSEY
 SCALE: 1"=400'
 JANUARY 2008
 JAMES A. MOTT, PE, PLS
 PROFESSIONAL ENGINEER & LAND SURVEYOR
 NEW JERSEY LICENSE NO. 29918
 3122 FIRE ROAD
 EGG HARBOR TOWNSHIP, NJ 08234

THIS SHEET HAS BEEN DRAWN USING
COMPUTER AIDED DRAFTING/DESIGN (CAD/D).