

SHEET 63

SHEET 59

SHEET 61

TAX MAP
 CITY OF ATLANTIC CITY
 ATLANTIC COUNTY, NEW JERSEY
 SCALE: 1" = 50'
 DATE: AUG. 1995
 ROBERT BADGER
 MUNICIPAL LAND SURVEYOR
 OFFICE OF THE CITY ENGINEER
 PLANNING DEPT., NEW JERSEY STATE HOUSE

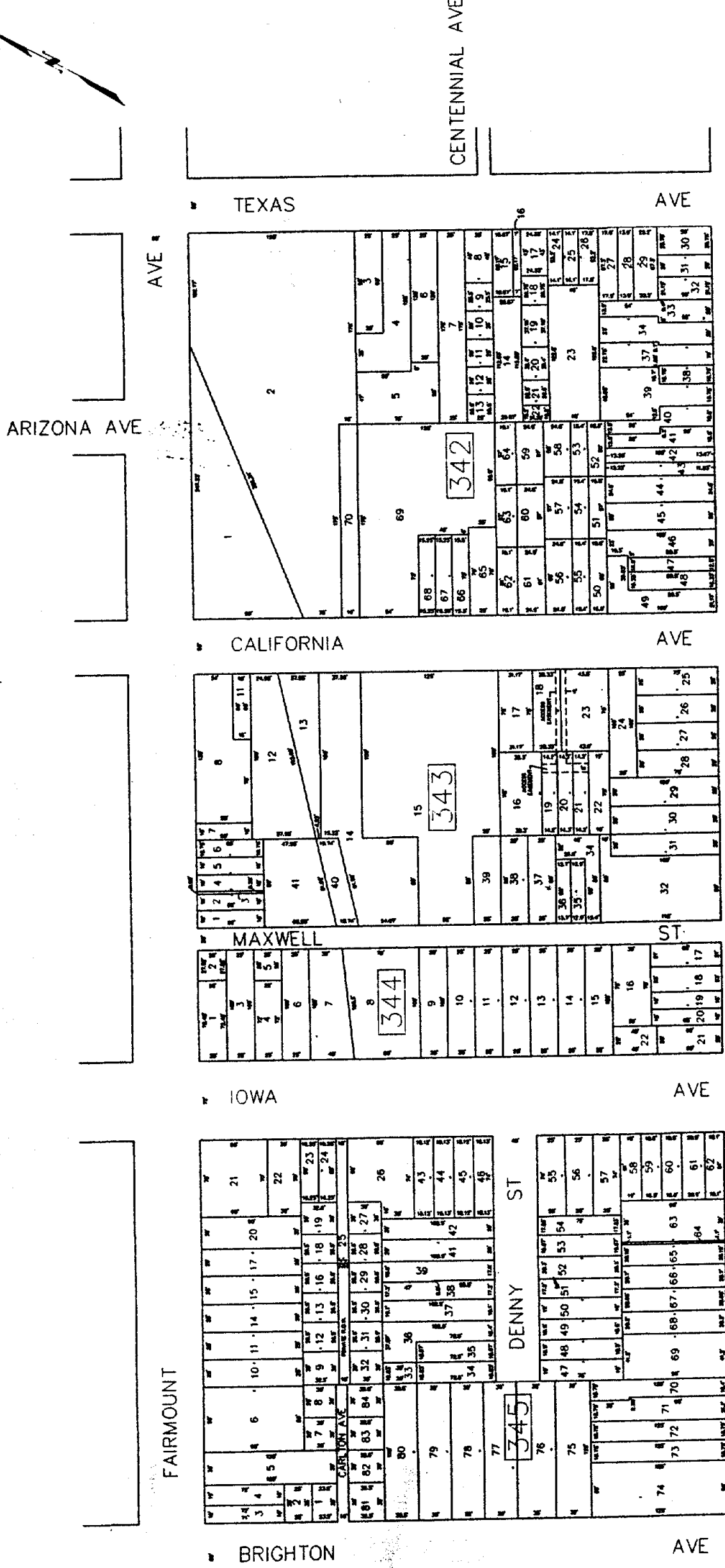

MARSHALL ST

STENTON PL

SHEET 45

| REVISIONS | |
|-----------|-----|
| DATE | BY |
| 3/20/1998 | DWP |
| 3/20/1998 | CHM |
| 3/23/1998 | CHM |
| 7/29/1998 | DWP |