

SHEET 71

SHEET 48

TAX MAP
 CITY OF ATLANTIC CITY
 ATLANTIC COUNTY, NEW JERSEY
 SCALE: 1" = 50'
 DATE: AUG 1995
 ROBERT BADGER
 JUNIOR LAND SURVEYOR
 OFFICE OF THE CITY ENGINEER
 ATLANTIC CITY, NEW JERSEY

REVISIONS	
DATE	BY
9/10/1998	DWP
BLK 331; CORSE 1-18, 20, 21, 22, 24-33	
BLK 332: 1-11, 13, 16, 18, 20-43	
INTD BLK 331; LOTS 1, 2, 3, 4, 5, 6, 7 & 8	
1/8/1999	DWP
BLK 327; CORSE 2 TO 10 INTO 2	
& REV. GEOM. LOT 1	
(WIDENING M.L.K. BLVD.)	

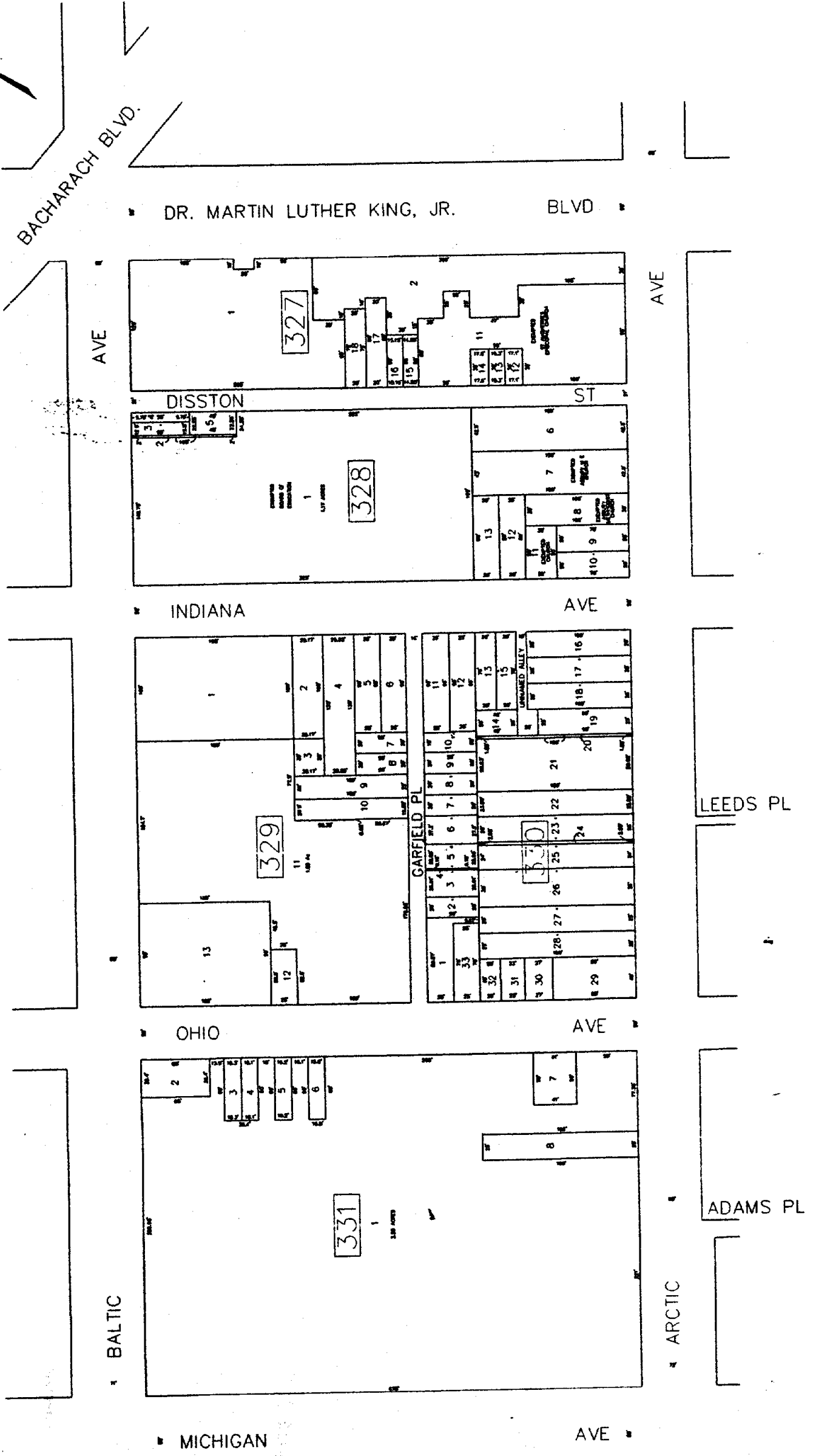

BACHARACH BLVD.

DR. MARTIN LUTHER KING, JR. BLVD

AVE

DISSTON ST

328

INDIANA AVE

329

GARFIELD PL

LEEDS PL

OHIO AVE

331

BALTIC AVE

ADAMS PL

MICHIGAN AVE

DIVISION ST

ARCTIC AVE