

SHEET 45

SHEET 33

SHEET 31

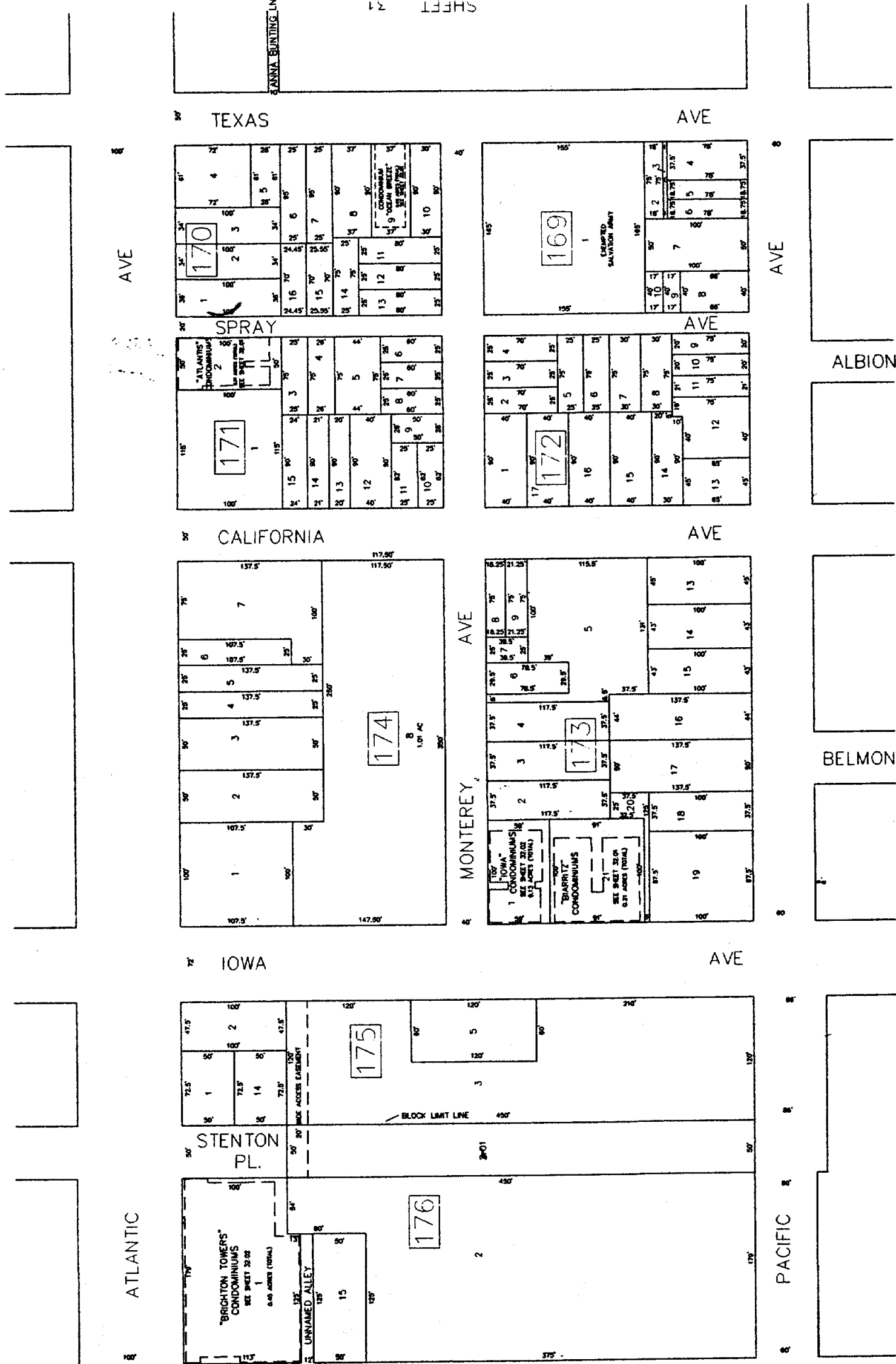

REVISIONS	
DATE	REVISIONS
3/20/1998	BLK 173; CONSL. 5,10,11 & 12 INTO 5
2/4/1999	BLK 175; CONSL. 3,4,6,7,8,9,10,11,12,13 INTO 3
2/4/1999	BLK 176; CONSL. 2,3,4,5,6,7,8,9,10,11,12,13,14 INTO 2
2/4/1999	VACATE P/O STENTON PL. - BLK. 176, LOT 2.01

TAX MAP
 CITY OF ATLANTIC CITY
 ATLANTIC COUNTY, NEW JERSEY
 SCALE: 1" = 50'
 DATE: AUG 1995
 ROBERT BADGER
 MANHATTAN LAND SURVEYOR
 NEW JERSEY LICENSE NO. 19920
 OFFICE OF THE CITY ENGINEER
 ATLANTIC CITY, NEW JERSEY 08401

SHEET 5 | SHEET 6