

NOTE:
THIS SHEET HAS BEEN REDRAWN USING COMPUTER AIDED DRAFTING/DESIGN
(CADD) BASED ON THE MAP PREPARED BY: RONALD J. PRICE, N.J. LICENSE NO. 13901
NORTHFIELD, NEW JERSEY.

BLOCKS 8 & 9.02, LOT 4

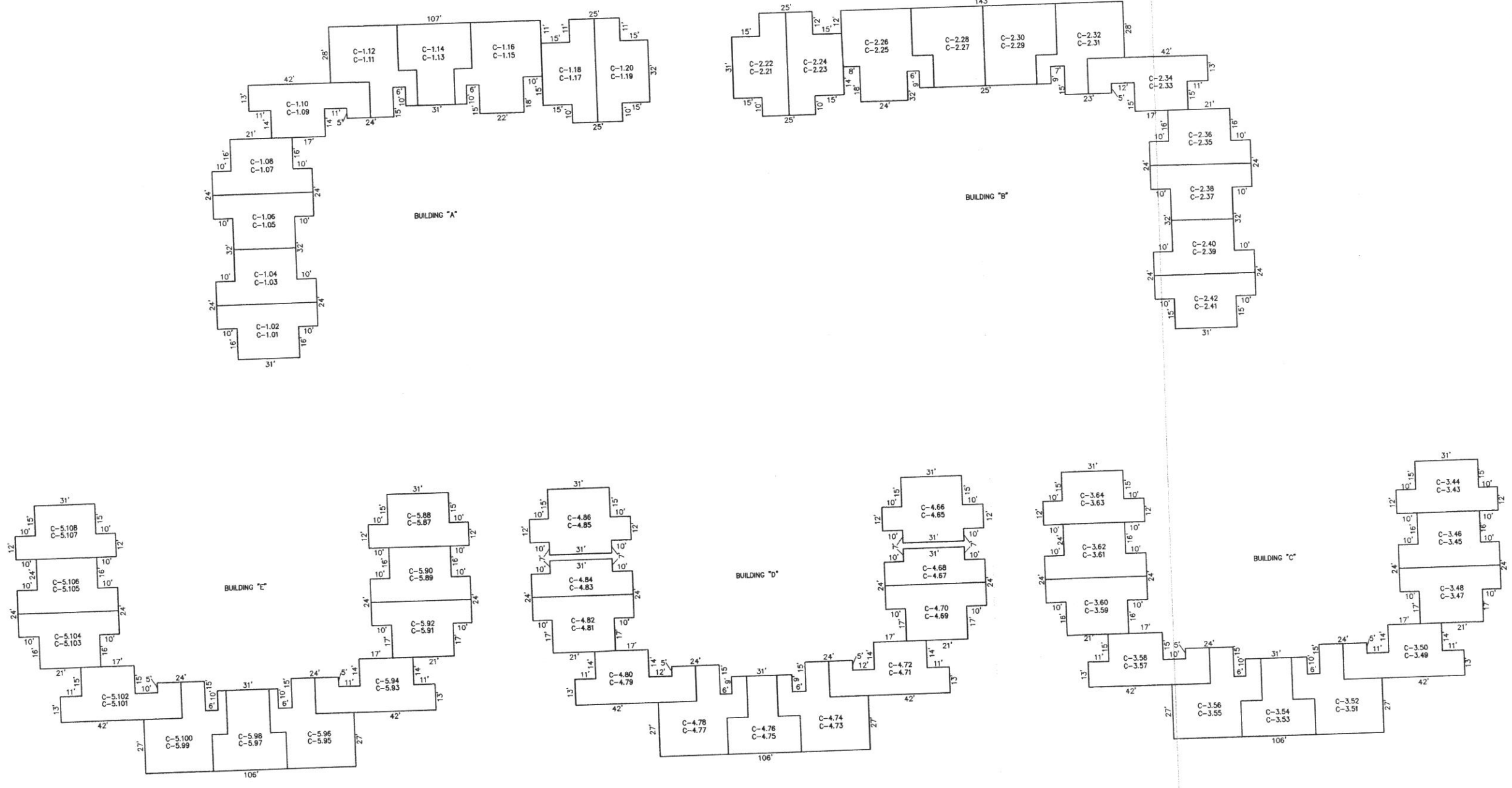

NOTE: DIMENSIONS AND SQUARE FOOTAGE ARE TYPICAL FOR SIMILAR UNITS
DETAILS
SCALE: 1"=30'

PLATE 3
BLOCKS 8 & 9.02, LOT 4
WOODLAND VILLAGE CONDOMINIUM
INSET "A"

NEW JERSEY DEPARTMENT OF THE TREASURY
DIVISION OF TAXATION
PROPERTY ADMINISTRATION
APPROVED AS A TAX MAP PURSUANT TO THE AUTHORITY OF
N.J.A.C. 17:27 & 17:28
FOR THE DIRECTOR, DIVISION OF TAXATION
Thomas C. DiDonato C.T.A.
THOMAS C. DI DONATO, CHIEF, LOCAL PROPERTY, FIELD ASSISTANCE
Stefano C. DiDonato C.T.A.
STEFANO C. DI DONATO, SUPERVISOR, FIELD REPRESENTATIVE
DATE: 01/13/2010 SERIAL NO. 079

TAXMAP
CITY OF ABSECON
ATLANTIC COUNTY NEW JERSEY
SCALE: 1" = 30' DATE: 11-10-2005
CRAIG F. REMINGTON LAND SURVEYOR LIC. NO. 23924
REMINGTON, VERNICK & WALBERG ENGINEERS
845 N. MAIN STREET, PLEASANTVILLE, NJ 08232
(609) 645-7000, FAX (609) 645-7076
WEB SITE ADDRESS: WWW.RVE.COM